

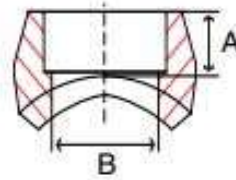

# Socket Weld Outlets, Class 3000

## Forged 316 Stainless Steel

### Inches / Pounds



Part #	NPS Pipe Size (inch)	For Nominal Pipe Sizes	(A) Socket Depth	(B) Hole Diameter	Approximate Weight Each
K3SWO.25-.375X36SS	1/4	3/8" thru 36"	0.81	0.49	0.10
K3SWO.375-.5X36SS	3/8	1/2" thru 36"	1.00	0.62	0.20
K3SWO.5-.75X36SS	1/2	3/4" thru 36"	1.06	0.82	0.30
K3SWO.75-1X36SS	3/4	1" thru 36"	1.31	1.04	0.50
K3SWO1-2X36SS	1	2" thru 36"	1.31	1.38	0.80
K3SWO1.25-3.5X36SS	1-1/4	3-1/2" thru 36"	1.37	1.61	1.00
K3SWO1.5-5X36SS	1-1/2	5" thru 36"	1.50	2.06	1.70
K3SWO2-8X36SS	2	8" thru 36"	1.81	2.46	2.90
K3SWO2.5-10X36SS	2-1/2	10" thru 36"	2.00	3.06	4.20
KSWO3-8X36SS	3	8" thru 36"	2.50	4.75	13.10

*\*Forged fitting material conforms to ASTM A182 grade F316/316L*

*\*Manufacturing facility is ISO 9001:2008 Certified*

*\*Dimensions conform to MSS SP-97*